

Dimension	249-80	249-81	249-82	249-83
A	.500"-.495"	.625-.620"	.500"-.495"	.625-.620"
B	.625"	.625"	.625"	.625"
C	1/2-28 NS 3A	5/8-24 NS 3A	1/2-28 NS 3A	5/8-24 NS 3A
D	.505"	.575"	.505"	.575"

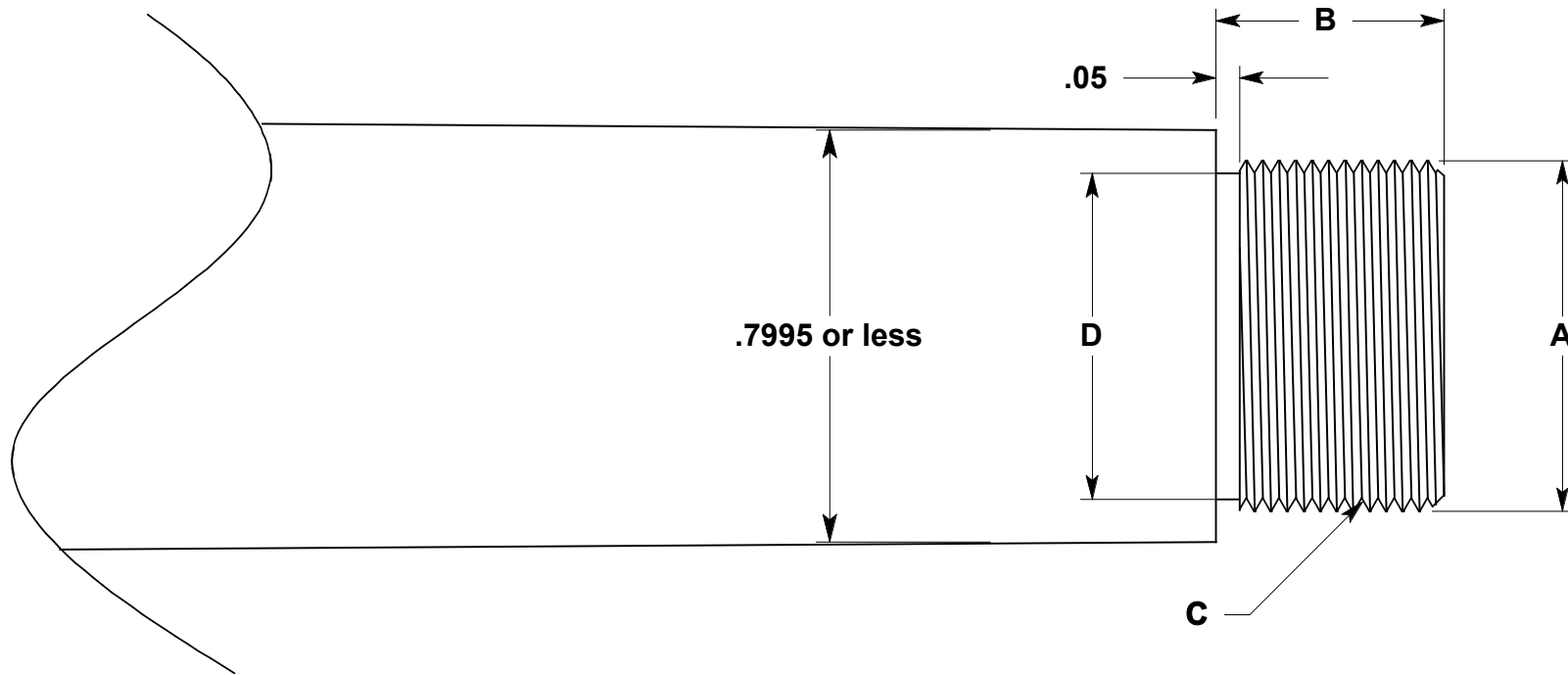

**WARNING!** This Muzzle Brake must be installed by a competent gunsmith.

The 249-81 and 249-83 are bored to clear a .308 caliber bullet, if you are using a larger caliber read instructions below.

**Fitting:**

1. You must bore the I.D. of the comp to fit the caliber of the rifle, do not drill the bore, use a boring bar.
2. To determine the correct diameter for the comp's I.D. Take the bullets O.D. and add .020" (example: .308 bullet dia. +.020"=.328")

Unless otherwise specified  
 Diminions are in Inches  
 TOLERANCES:  
 ANGLES ± .5°  
 FRACTIONS ±.015  
 .00-.01  
 .000-.005  
 .0000-.0005

**BADGER**  
**ORDNANCE**

1209 Swift St  
 816 421-4956

N. Kansas City, MO. 64116  
 FAX 816 421-4958

**Mini & Micro FTE Barrel print**

Dwg No.	249-82-3	Part No.	249-82 249-83
Scale: NST	Date: 1 Sept. 2013	Page	1 of 1

ENGINEER: M. BORDSON