

Use of the 1005-223-02 Gas Cylinder Alinement Gage for use with M14/M1A rifle

This Gage is used to determine if the gasport in the barrel is in alinement with the gas hole in the gas cylinder.

1. With the weapon safe and unloaded, remove the action from the stock.
2. Remove the Gas Cylinder plug and unscrew the gas cylinder lock, (fig. 1) and remove gas piston.

3. With the gas cut-off valve open (fig. 1) insert gage into relief hole. The gage should protrude a minimum of 1" into the gas cylinder. (fig. 2)
4. If the gage fails to protrude the 1" min., this indicates an out-of-specification barrel or gas cylinder, the barrel flange can be set back to allow the Cylinder to move rearward. If the gage inserts the minimum amount and the Barrel Band is loose, shims may be installed to tighten the Gas Cylinder. Poor barrel/gas cylinder timing can result in a malfunctioning or inaccurate weapon.

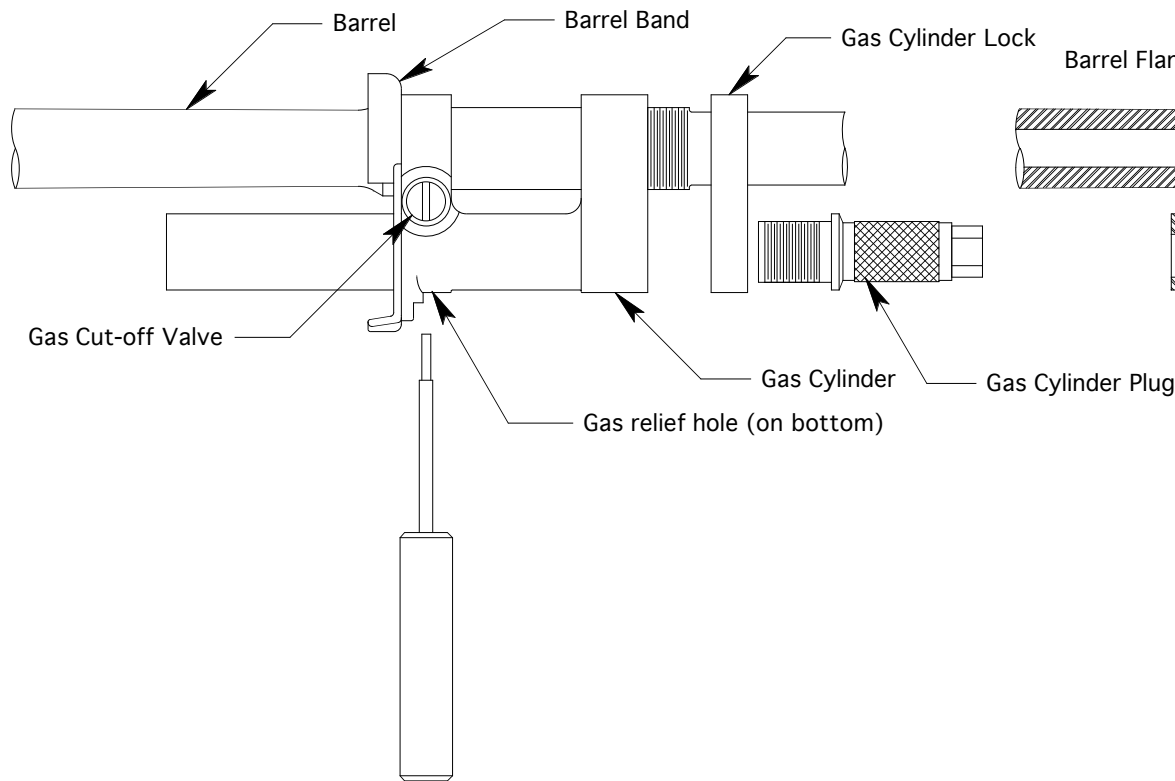

fig. 1

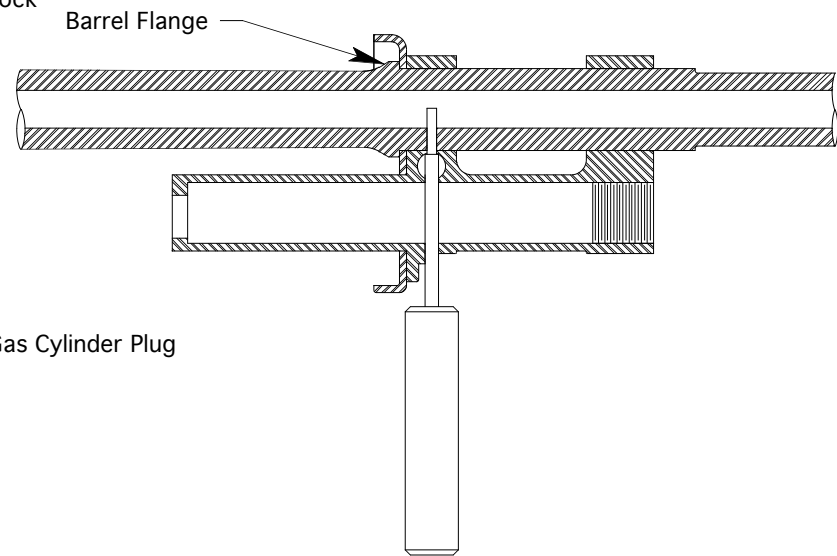

fig. 2